

## Tridis, Deep Tridis, Tridis 40 & Goblet Pleat

### What you will need:

1. Rufflette Tridis, Deep Tridis, Tridis 40 or Goblet Pleat curtain heading tape
2. Your chosen fabric
3. Matching thread
4. Tridis R10 curtain hooks - approx. 4 hooks per metre
5. Rufflette cord tidy ( x 2 - one for each curtain)
6. Rufflette lead penny weights (x 4 - one for the corner of each curtain)

### Working out **tape** requirements:

Multiply the width of the track/pole by the fullness  
i.e. 2 1/4 for Tridis, Deep Tridis, Tridis 40 & Goblet Pleat.

e.g

Width of track/pole: 183cm (72")  
Multiply by 2 1/4: 2 1/4 x 183cm (72")  
Total tape required: 412cm (162")

Remember to add on required amount of tape if using a track with an overlap arm.

### Helpful Tips:

**Measuring your window** - When measuring your window use a steel or wooden rule. Do not use a cloth tape as this may stretch.

**Required Fullness** - With these tapes we recommend 2 1/4 fullness as you need to attach the tapes at a specific point. If the correct fullness is not used you may not have enough tape to make your curtains!

### Sewing Instructions:

1. Taking the edge of the tape that will come to the centre of the track or pole (remember you will require a left and right hand curtain) cut in the centre of a group of pleats where marked on the heading tape, to free cords for knotting.
2. Knot each free cord and trim tape to within 3cm of the knots.
3. If you have an overlap arm on the track, turn under 4cm of tape. If the curtains butt together at the centre of the track, turn under 9cm of tape.
4. At the opposite edge of the tape, pull out 3-5cm

### Working out **fabric** requirements:

1. To calculate the number of fabric widths required, multiply the total width of the track by 2, then divide by the width of your chosen fabric - 137cm (54"). Round up to the nearest full number.

2. Multiply the curtain length by the number of fabric widths, adding the following allowances to each fabric width:

i. 10cm (4") per fabric width for hems and heading.

ii. 2.5cm (1") approximately, per fabric width for shrinkage.

3. Allow additional fabric for pattern matching - the general rule is one full pattern repeat per fabric width. For example, curtains requiring 4 fabric widths need additional fabric for 3 pattern repeats.

e.g

Width track/pole: 60"  
Width of chosen fabric: 54"

$60" \times 2 = 120"$  then divide by  $54" = 2.22$  widths  
Round to 2.5 i.e 1.25 widths of fabric for each curtain.

Drop: 85"  
Multiply curtain length by number of fabric widths.  
 $85" \times 2.5 = 212.5"$   
Add 8" for hems and 2.5" for shrinkage = 223"

Therefore total fabric required = **5.75 metres**

(Don't forget to add on any extra fabric for pattern repeats if required)

of cords for eventual pleating of the curtain. If the cords are not exposed, use the point of your scissors to pick them free from the channel of the tape.



5. Turn and press a 6mm hem at the top of your curtain. Ensure that the tape is the correct way up - yellow line at the bottom, and that the hook pockets are facing you. Machine the tape to the curtain along the turquoise sewing lines, leaving 3mm between the top of the tape and the top of the curtain. The top and bottom rows must be stitched in the same direction. Sew both side edges of the tape, but do not sew over the free cords for pleating.

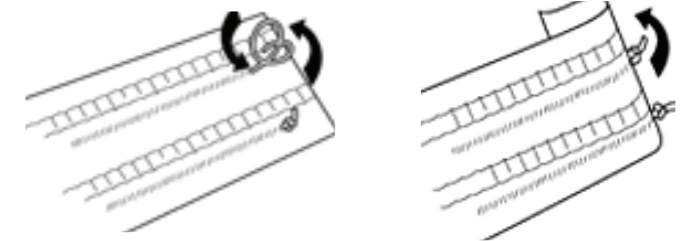

### Pleating Instructions:

1. It is very important to pleat up the curtain correctly and to avoid puckering between the pleats. Hold the free cords in one hand or loop them round a door handle.

(Tridis, Deep Tridis & Tridis 40)

2. Position fingers as indicated. Push the first set of pleats into position and advance to second set also pushing them into position. Now return to first set as these will have come out and advance and return along the curtain until the whole curtain is pleated. Tie a slip knot to hold.

(Goblet Pleat)

2. Pull the top cord, pushing the first goblet into position. Then form the bottom pleat by pulling the bottom drawcord until the two outer pleats meet and the four pinch pleats form the stem of the goblet. Advance the first goblet pleat to the position of the second goblet pleat then return to form the first goblet again. Advance the pleats along the tape until the whole curtain is pleated. Tie a slip knot to hold.

3. Do not cut off surplus cords as they allow the curtain to be pulled flat for cleaning. Loose cords should be wound neatly out of sight on a Rufflette Cord Tidy.

4. Using only the special Tridis Tape Hooks R10, fit by inserting one of the two prongs into each of the two adjacent pockets at the back of each set of pleats and into adjacent pockets at each end of the curtain. Then push the hook up and over until the two prong are at the front facing downwards, ready to insert into your curtain rings.

5. When attaching loose linings, a single prong of the Tridis Hook is placed through the buttonhole of the lining tape then each prong is inserted into the Heading Tape as previously described. If you wish to suspend the curtains below the track or pole use the top row of pockets for the curtain hooks. If you require the track to be covered, the bottom row should be used.

6. The pleating effect of these headings will be improved if a small tack is used to pinch the base of each pleat.

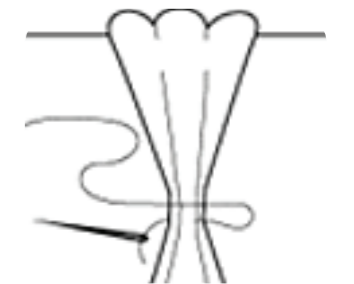
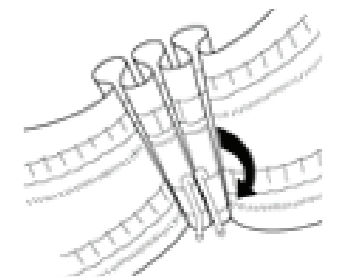
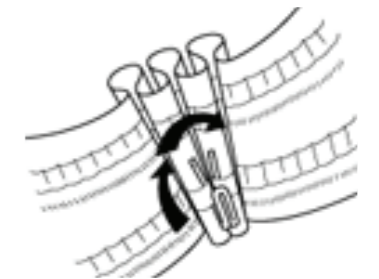
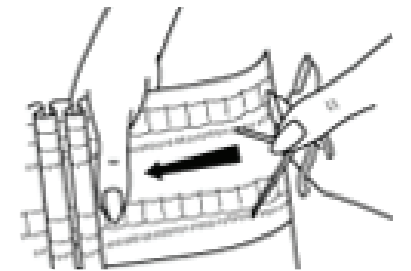

### Contact us:

If you experience any problems while using this tape and making your curtains do not hesitate to contact our Customer Services Dept. (via any of the methods below) who will be happy to help you out.

Rufflette Limited  
Sharston Road  
Wythenshawe  
Manchester  
M22 4TH

Tel no. 0161 998 1811  
Fax no. 0161 945 9468  
Email. customer-care@rufflette.com